

STEINEL ultrasonic technology.  
The USA standard.



DualTech

CONTROL  
PRO  
SYSTEM



DualTech



US 360



Dual US



Single US

Indoors	•	•	•	•
COM1	•	•	•	•
COM2	•	•	•	•
DIM	•	•	•	•
Sensor	Ultrasonic + PIR	Ultrasonic	Ultrasonic	Ultrasonic
Installation height	2.5–3.5m	2.5–3.5m	2.5–3.5m	2.5–3.5m
Detection zones	Presence: Ø6m	Presence: Ø6m	Radial: 3x20 m max. Tangential: 3x20 m max.	Radial: 3x10 m max. Tangential: 3x10 m max.
Page	104	106	108	110

**Standard in the USA.  
From STEINEL in premium quality.**

We are a company that operates on the global stage. "When in Rome, do as the Romans do": this saying applies to us in a technological sense too. In the USA, for example, ultrasonic sensors define the standard. Needless to say, as innovation and technology leader, we manufacture high-end sensors on the basis of ultrasonic technology and also let all STEINEL customers benefit from the advantages this system has to offer.

The ultrasonic waves (40 kHz) are actively emitted from the sensor and completely fill the respective room. They permeate into every last corner, enveloping objects that are present in the room. The sensor identifies movement in the room even if there is no visual contact between sensor and person. The signal is evaluated on the basis of the Doppler principle. It is this that makes ultrasonic sensors ideal for open-plan offices and rooms with stud walls. Ultrasonic waves do not penetrate thin walls and are highly sensitive. And therefore particularly recommended for rooms in which sedentary activities are performed.

# Single US

## The ideal sensor for small corridors.

Simple tasks demand simple answers. This is demonstrated by our Single US 180° ultrasonic sensor. Correctly aligned, it detects any movement in corridors and passage-ways of up to 10 metres in length – even if they take place behind objects. Movements in adjacent rooms, however, are not detected. This means the sensor only switches light on when it's really needed.

CONTROL  
PRO  
SYSTEM



  
ultrasonic  
sensor 180°

  
3x10m

**2000w**  
max.

**DIM**  
1 - 10V

  
indoor  
sensor

  
2.5 - 3.5m

  
10 - 1000 lux

**TEACH**  
mode

**iQ**  
IQ-mode

  
energy  
saving

**5**  
functional  
warranty



EAN Single US COM1 .....	4007841 007966
EAN Single US COM2 .....	4007841 007973
EAN Single US DIM .....	4007841 007980
Type .....	Presence detector
Dimensions (H x W x D) .....	120 x 120 x 73 mm
Power supply .....	220–240 V, 50/60 Hz
Sensor type .....	Ultrasonic 40 kHz
Where to use .....	Indoors
Installation .....	Ceiling
Recommended installation height .....	2.5 - 3.5 m
Angle of coverage .....	Corridor, one direction
Reach .....	3x10m
Parallel-connected configurations .....	Yes
User-friendly setting .....	Teach-In (via optional remote control RC 8)
Response brightness .....	10 - 1000 lx
Response brightness, DIM .....	100–1000lx, ∞/daylight
IP rating .....	IP20
Protection class .....	II
Temperature range .....	-25 to +55°C
Enclosure .....	UV-resistant plastic, paintable
For information on the interfaces, please turn to page 112.	

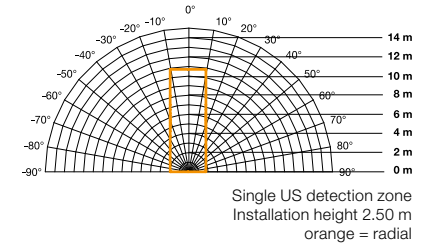
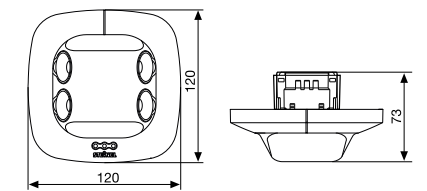

### Accessories

EAN user remote control RC5 .....	4007841 592806
EAN service remote control RC8 .....	4007841 559410
EAN surface-mounting adapter AP Box .....	4007841 000363
EAN guard cage .....	4007841 003036

Optional remote  
controls refer to  
page 300



Optional  
surface-mounting  
adapters refer to  
page 300



Optional guard cage  
refer to page 300

