

Extremely slim and sensitive.



The IR Quattro SLIM is as good as invisible. We have not only developed the slim presence detector for planners and architects. Just imagine the options that virtually invisible sensor technology can give you. Combining intelligent technology and superb, stylishly understated design, the detector fits almost flush with the ceiling for an aesthetically pleasing look. An overall depth of just 4 mm means it can be installed almost in line with the ceiling surface. Leaving you to save energy without any compromise.

The technology behind the IR Quattro SLIM gives you everything you could wish for as well. With a level of performance that's nothing short of impressive. The newly developed retina lens provides a square detection footprint despite the unit's extremely slim-line design. Needless to say, the IR Quattro SLIM is also available in COM1, COM2, DIM, DALI and KNX versions. It can also be operated by optional remote control. Nobody escapes the detector's watchful eye in a square, 4 x 4 m presence detection zone.

This presence detector responds to even the tiniest movements with its extremely high-definition, precision sensor technology. This is important indoors, particularly in conjunction with sedentary activities - e.g. in offices for desk work or in classrooms.

IR Quattro SLIM

**Genuine 16 m² of presence detection.
Compressed into 4 mm.**

Sensor technology is a must in many buildings today. But not without aesthetic appeal, please! This is precisely where the IR Quattro SLIM infrared presence detector comes in. With an overall depth of just 4 mm, it can be installed almost flush with the ceiling where it remains practically invisible to anyone looking up. As the only one of its kind in the world, the retina lens deserves all the more attention. Installed at a height of up to 4 metres and despite being so slim, it provides a true presence detection zone of an astonishing 16 m².

CONTROL
PRO
SYSTEM



Infrared sensor
max. 4 m x 4 m
presence

2000w
max.

DIM
1-10 V

DALI
2 channels

2,5-4m

10-1000 lux
with RC8

1 min-15 Min.
with RC8

TEACH
mode
with RC8

iQ
IQ-Modus

5 JAHRE
GARANTIE
functional
warranty

EAN IR Quattro SLIM COM14007841 593414
EAN IR Quattro SLIM COM24007841 593513
EAN IR Quattro SLIM DIM4007841 593612
EAN IR Quattro SLIM DALI4007841 005795

You will find the KNX version on page 130.

Type Presence detector
Dimensions (H x W x D), sensor module 77 x 77 x 60 mm
Dimensions (H x W x D), load module 61.3 x 126.5 x 42.5 mm
Power supply 120-250V, 50/60Hz
Sensor type Passive infrared
Where to use Indoors
Installation Ceiling
Recommended installation height 2.5 - 4 m
Output (resistive load,
cos φ = 1, e.g. all-purpose lamp) 2000W max. for 230V
..... 1000W max. for 120V
Output (uncorrected, inductive,
cos φ = 0.5, e.g. fluorescent lamps) 1000W max. for 230V
..... 500W max. for 120V
Inrush current 800 A / 200 μs max.
Electronic ballast 30x (1x18W), 25x (2x18W)
..... 25x (1x36W), 15x (2x36W)
..... 20x (1x58W), 10x (2x58W)
Parallel connection capability Yes
Square detection zone, presence 4 x 4 m (16 m²) max.
Square detection zone, radial 4 x 4 m (16 m²) max.
Square detection zone, tangential 4 x 4 m (16 m²) max.
Sensor system PIR with retina lens and hexagonal Fresnel structure
Parallel-connected configurations Master/master, master/slave
User-friendly setting Teach-In (with optional remote control RC8)
Response brightness 10-1000 lux, ∞/daylight
Response brightness, DIM/DALI 100-1000 lux, ∞/daylight
IP rating IP20
Protection class II
Temperature range 0 to +40 °C
IQ mode Yes
Enclosure UV-resistant, paintable
For information on the interfaces, please turn to page 112.

Accessories

EAN user remote control RC54007841 592806
EAN service remote control RC84007841 559410
EAN 6m extension cable4007841 006419
Refer to the 'Accessories' section for further information.

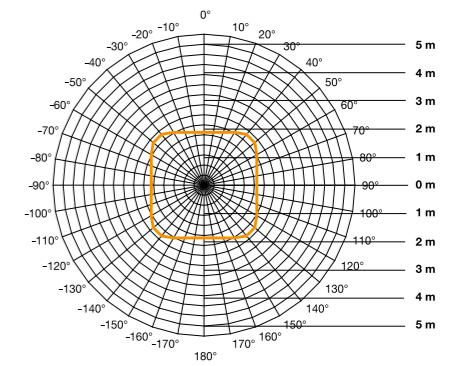
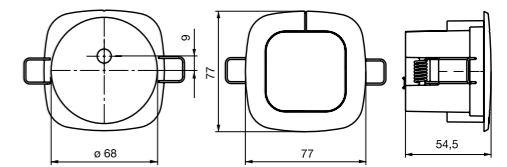

IR Quattro Slim detection zone
Installation height 2.80 m
orange = tangential, radial, presence



Extremely slim
overall height



High-quality retina lens



Can only be set by
optional remote con-
trol RC8

